



CTEK MXS 5.0

5 A



NEW
GENERATION
BATTERY CHARGERS

NEW GENERATION TECHNOLOGY AVAILABLE FOR THE CONSUMER CTEK MXS 5.0

5
YEAR
WARRANTY

The MXS 5.0 is a charger that offers state of the art technology that was previously only found in CTEK's professional product range. The charger can solve a broad range of battery-related problems and is the perfect charger for those with high demands. The MXS 5.0 offers features such as battery diagnosis that shows if a battery can receive and retain a charge, a special reconditioning function that restores stratified and deeply discharged batteries, unique maintenance charging, a mode for optimised charging during cold winter days and the charging of demanding AGM batteries (i.e. Optima). The unique display allows the user to follow the entire charging process.

The MXS 5.0 is a fully automatic 8-step charger that delivers selectable 0.8 A or 5 A to 12 V batteries from 1.2 - 110 Ah and is suitable for maintenance charging up to 160 Ah. The charger is IP65 classified (splash and dust proof), designed to protect vehicle electronics and non-sparking, reverse polarity protected and short-circuit proof. It is delivered with a 5-year warranty.



Fully automatic for optimal charging



For all lead-acid batteries



FULLY CHARGED BATTERY



Maintenance charging



For charging in cold conditions and AGM batteries

RECOND

Recondition of deeply discharged batteries



TECHNICAL DATA

CHARGING VOLTAGE	14.4/14.7/15.8 V
CHARGING CURRENT	Max 5 A
TYPE OF CHARGER	8 step, fully automatic charging cycle
TYPE OF BATTERY	12 V lead-acid batteries
BATTERY CAPACITY	1.2 - 110 Ah, up to 160 Ah for maintenance
INSULATION	IP65 (splash and dust proof)



THE SMARTEST BATTERY CHARGERS IN THE WORLD



CTEK's UNIQUE 8 STEP CHARGING



- Fully automatic charging and maintenance in 8 steps maximizes battery life and performance
- Numerous accessories simplifies using the same charger for multiple batteries
- One charger for the car, motorcycle, lawn mower, snowmobile, sump pump and tractor
- Water-resistant so that the solution could be taken to the problem even if it rains or snows
- Patented maintenance charge for a unique combination of maximized life and performance
- Recondition of deep discharged batteries
- Patented desulphation that extends the battery life
- No sparks, short-circuit proof and reverse-polarity protected for untroubled usage
- Automatic detection of end-of-life batteries that eliminates surprises

CONNECT AND FORGET

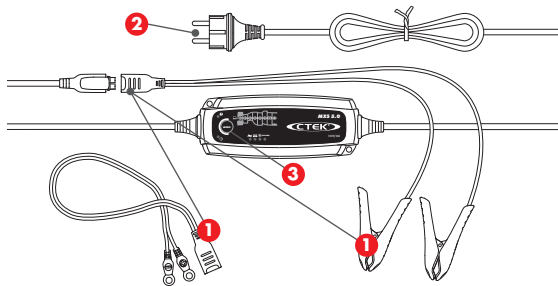

- 1. Connect the charger to the battery.**
- 2. Connect the charger to the wall socket.**
Power-on lamp lights
- 3. Press the MODE-button to select charging program.**

- Small sized batteries
- Medium sized batteries
- Charging in cold conditions and AGM batteries requiring 14.7 V charging

RECOND Reconditioning of deeply discharged batteries

4. ... and ready.

www.ctek.com

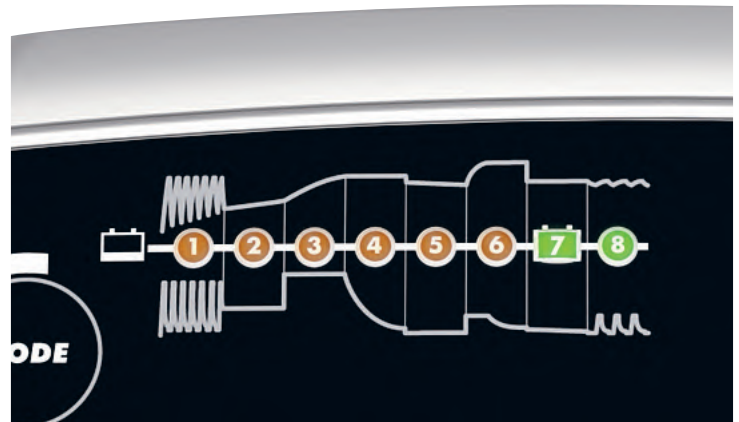

- 1 STEP 1 DESULPHATION**
Pulsing voltage removes sulphates from the lead plates of the battery restoring the battery capacity.
- 2 STEP 2 SOFT START**
Tests if the battery can accept charge. Charging begins if the battery is OK.
- 3 STEP 3 BULK**
Charging with maximum current until approximately 80 % battery capacity.
- 4 STEP 4 ABSORPTION, READY TO USE**
Charging with declining current to maximize up to 100 % battery capacity.
- 5 STEP 5 ANALYSE**
Tests if the battery can hold charge. Batteries that cannot hold charge may need to be replaced.
- 6 STEP 6 RECOND**
Reconditioning function for deeply discharged batteries.
- 7 STEP 7 FLOAT, FULLY CHARGED**
Maintaining the battery voltage at maximum level by providing a constant voltage charge.
- 8 STEP 8 PULSE, MAINTENANCE CHARGING**
Maintaining the battery at 95 - 100 % capacity. The charger monitors the battery voltage and gives a pulse when necessary to keep the battery fully charged.

GUARANTEED QUALITY WITH CTEK

CTEK customer support is available to answer any questions related to charging and CTEK chargers. Safety, simplicity and flexibility characterizes all products and solutions developed and sold by CTEK. CTEK supply chargers to more than 60 countries throughout the world. CTEK is also a reliable OEM supplier to many of the world's most prestigious car and motorcycle manufacturers.

Contact customer support: info@ctek.com



THE SMARTEST BATTERY CHARGERS IN THE WORLD